

Model 7AP

Ref.#	*Total Ratio	
	P/N	P/N
	155.31	96.23
36	236364	269386
45	236359	269390
71	236363	269388

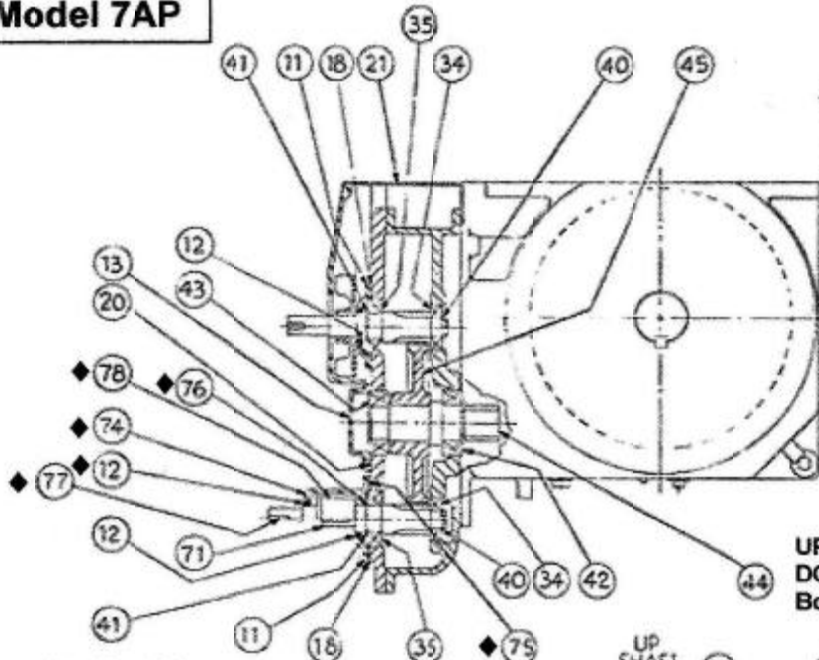

UP Shaft items labeled "A"
DOWN Shaft items labeled "B"
Both UP & DOWN Shaft No label

For unit without Formsprag Clutch, eliminate items marked with ♦ and replace with items 11 & 18

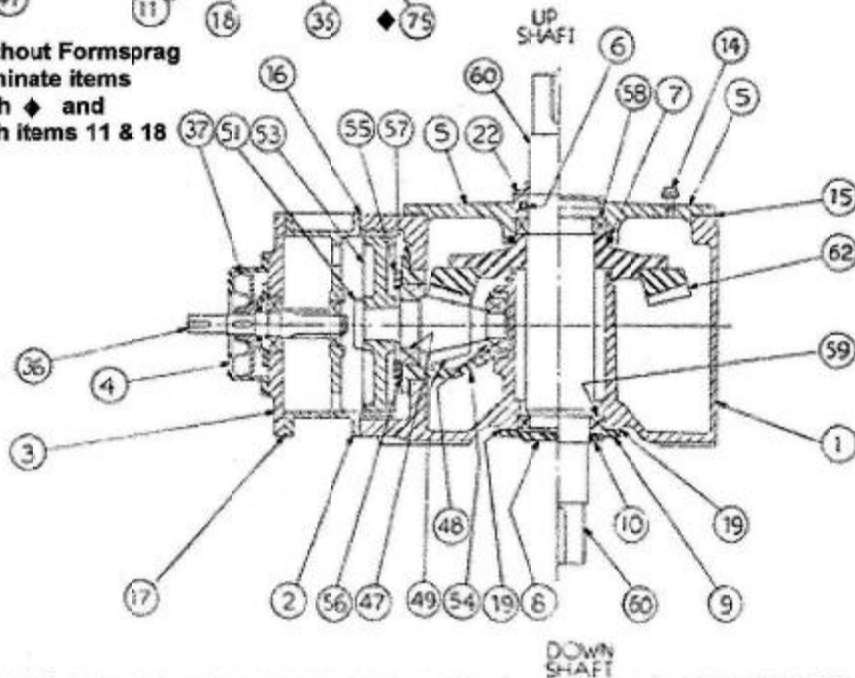

Ref. No.	Part Number	Description
1	504459	Housing
2,3	412484	H.S. Head & Bearing Plate Assembly
4	412519	H.S. Fan Housing
5A	412486	L.S. Upper Bearing Cage
5B	412485	L.S. Upper Bearing Cage
6A	912666	L.S. Retainer Oil Seal
7	912672	L.S. Upper Bearing Seal
8A	287168	L.S. Lower End Cover
9B	287169	L.S. Lower Oil Retainer
10B	912667	L.S. Lower Oil Seal
11	236287	H.S. Oil Retainer
12	912836	H.S. Oil Seal
13	320337	Intermediate End Cover
14	950027	Breather Assembly
15	320333	Upper Cage Shim Set
16	320334	H.S. Housing Gasket
17	320335	Bearing Plate Housing Gasket
18	180816	H.S. Retainer Gasket
19	171054	L.S. Retainer Shim Set
20	236306	Intermediate End Cover Shims
21	320338	Air Chamber Plate
22A	236486	Shaft Water Hood
34	919072	H.S. Pinion Inner Bearing
35	919056	H.S. Pinion Outer Bearing
36	Ratio Gear*	H.S. Pinion Shaft
37	320324	Fan
40	917004	Bearing Retainer Ring
41	917363	Bearing Retainer Ring
42	921731	Intermediate Inner Bearing
43	921732	Intermediate Outer Bearing
44	236366	Intermediate Pinion Shaft
45	Ratio Gear*	H.S. Gear
47	921733	Bevel Pinion Inner Bearing
48	921734	Bevel Pinion Outer Bearing
49	412502	Bevel Pinion
51	180896	Intermediate Gear Keeper Plate
53	236362	Intermediate Gear
54	412481	Bevel Pinion Bearing Cage
55	180804	Outer Bearing Thrust Plate
56	180805	Thrust Plate Shims
57	180806	Bearing Cage Shims
58	921362	L.S. Shaft Upper Bearing
59	921365	L.S. Shaft Lower Bearing
60A	412532	L.S. Shaft Assembly (UP)
60B	412531	L.S. Shaft Assembly (DOWN)
62	236151	Bevel Gear
71	Ratio Gear*	Aux. Pinion Shaft
74	412520	Clutch Housing
75	180815	Aux. Retainer Gasket
76	236485	Clutch Oil Dam
77	236365	Clutch Stub Shaft
78	951301	Clutch
79	765760	Shim Pack

Penn Machine Company / Rail Trans Division

310 Innovation Drive
Blairsville, PA 15717

Ph 724-459-0302 Fax 724-459-0305
Emergency & After Hours 724-309-4185

Parts Guide For Air Preheater Model 7AP

Saved as ABB-7AP layout.doc
DM 5-07-02

511340