

Model 7AP

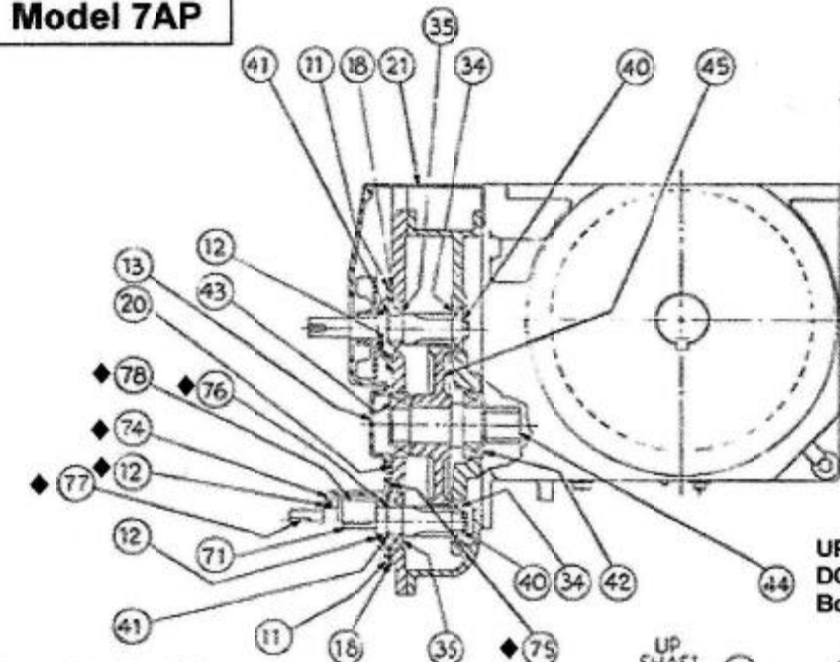

| Ref.# | *Total Ratio | |
|-------|--------------|--------|
| | P/N | P/N |
| | 155.31 | 96.23 |
| 36 | 236364 | 269386 |
| 45 | 236359 | 269390 |
| 71 | 236363 | 269388 |

UP Shaft items labeled "A"
 DOWN Shaft items labeled "B"
 Both UP & DOWN Shaft No label

For unit without Formsprag
 Clutch, eliminate items
 marked with ♦ and
 replace with items 11 & 18

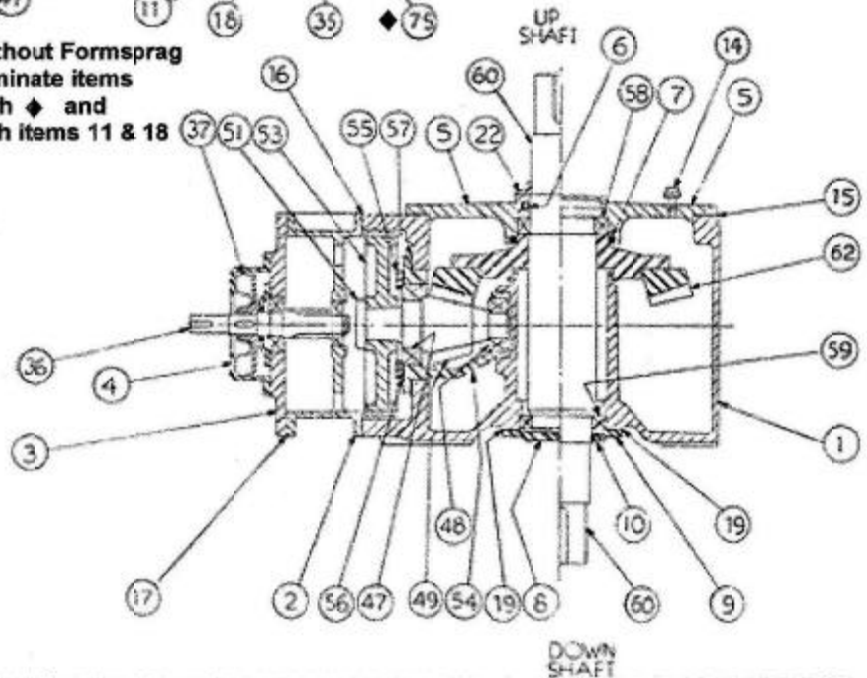

| Ref. No. | Part Number | Description |
|----------|-------------|------------------------------------|
| 1 | 504459 | Housing |
| 2,3 | 412484 | H.S. Head & Bearing Plate Assembly |
| 4 | 412519 | H.S. Fan Housing |
| 5A | 412486 | L.S. Upper Bearing Cage |
| 5B | 412485 | L.S. Upper Bearing Cage |
| 6A | 912666 | L.S. Retainer Oil Seal |
| 7 | 912672 | L.S. Upper Bearing Seal |
| 8A | 287168 | L.S. Lower End Cover |
| 9B | 287169 | L.S. Lower Oil Retainer |
| 10B | 912667 | L.S. Lower Oil Seal |
| 11 | 236287 | H.S. Oil Retainer |
| 12 | 912836 | H.S. Oil Seal |
| 13 | 320337 | Intermediate End Cover |
| 14 | 950027 | Breather Assembly |
| 15 | 320333 | Upper Cage Shim Set |
| 16 | 320334 | H.S. Housing Gasket |
| 17 | 320335 | Bearing Plate Housing Gasket |
| 18 | 180816 | H.S. Retainer Gasket |
| 19 | 171054 | L.S. Retainer Shim Set |
| 20 | 236306 | Intermediate End Cover Shims |
| 21 | 320338 | Air Chamber Plate |
| 22A | 236486 | Shaft Water Hood |
| 34 | 919072 | H.S. Pinion Inner Bearing |
| 35 | 919056 | H.S. Pinion Outer Bearing |
| 36 | Ratio Gear* | H.S. Pinion Shaft |
| 37 | 320324 | Fan |
| 40 | 917004 | Bearing Retainer Ring |
| 41 | 917363 | Bearing Retainer Ring |
| 42 | 921731 | Intermediate Inner Bearing |
| 43 | 921732 | Intermediate Outer Bearing |
| 44 | 236366 | Intermediate Pinion Shaft |
| 45 | Ratio Gear* | H.S. Gear |
| 47 | 921733 | Bevel Pinion Inner Bearing |
| 48 | 921734 | Bevel Pinion Outer Bearing |
| 49 | 412502 | Bevel Pinion |
| 51 | 180896 | Intermediate Gear Keeper Plate |
| 53 | 236362 | Intermediate Gear |
| 54 | 412481 | Bevel Pinion Bearing Cage |
| 55 | 180804 | Outer Bearing Thrust Plate |
| 56 | 180805 | Thrust Plate Shims |
| 57 | 180806 | Bearing Cage Shims |
| 58 | 921362 | L.S. Shaft Upper Bearing |
| 59 | 921365 | L.S. Shaft Lower Bearing |
| 60A | 412532 | L.S. Shaft Assembly (UP) |
| 60B | 412531 | L.S. Shaft Assembly (DOWN) |
| 62 | 236151 | Bevel Gear |
| 71 | Ratio Gear* | Aux. Pinion Shaft |
| 74 | 412520 | Clutch Housing |
| 75 | 180815 | Aux. Retainer Gasket |
| 76 | 236485 | Clutch Oil Dam |
| 77 | 236365 | Clutch Stub Shaft |
| 78 | 951301 | Clutch |
| 79 | 765760 | Shim Pack |

Penn Machine Company / Rail Trans Division

310 Innovation Drive
 Blairsville, PA 15717

Ph 724-459-0302 Fax 724-459-0305
 Emergency & After Hours 724-309-4185

Parts Guide For Air Preheater Model 7AP

Saved as ABB-7AP layout.doc
 DM 5-07-02

511340